

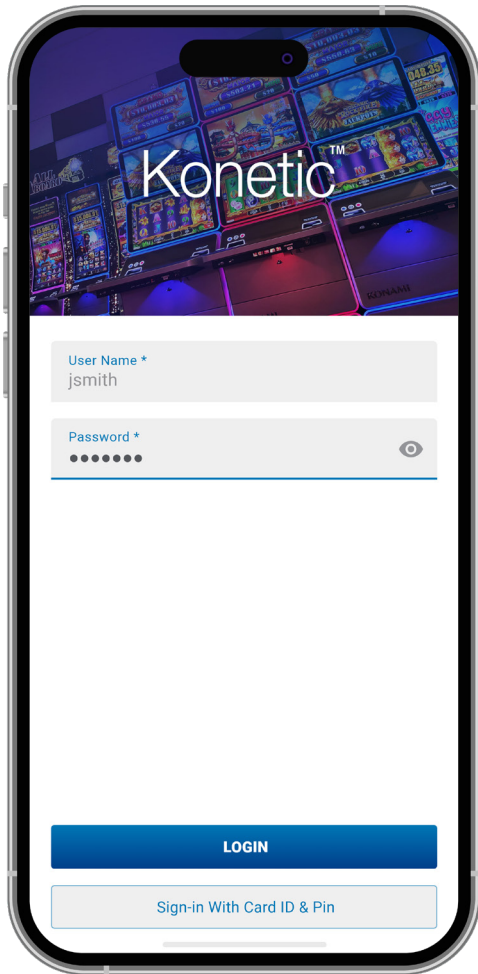

Konetic™

Connect employees to the information they need,
when they need it most.



The Konetic™ employee app empowers casino teams to perform various job tasks from a permissioned mobile device, for on-the-go information, efficiency, tracking, and response. Tied directly to Konami Gaming, Inc.'s award-winning SYNKROS® casino management system, Konetic enables casino employees to achieve new levels of customer service by assisting patrons right on the casino floor. Staff can reference, add, and update patron loyalty information on-the-go with Konetic's Patron module, and locate patrons and games through the Finder module—both targeted for launch with SYNKROS v4.2. Konetic also improves casino floor response times through its enhanced Dispatch module, which helps floor teams operate more efficiently through centralized assignments and tracking. And with the Cash Can module, permissioned employees can swap out cash cans to make soft drops and counts effortless via barcode scanning and automated swap out processes once each of the cans are entered.

Konetic is available for iOS and Android. The app is designed to leverage a smartphone's built-in camera for all barcode and ticket scanning.

AVAILABLE MODULES

ATTENDANT PAYS

CASH CAN

DISPATCH

PROGRESSIVE SIGNS

TITO REDEMPTION

FINDER*

PATRON*

*Scheduled for release in SYNKROS v4.2

DISPATCH

Konami's Konetic employee app improves slot floor personnel efficiency, accountability, and response time through a fully advanced Dispatch module. EGM or SYNKROS transactions can be configured to automatically generate service call alerts, which permissioned casino employees can view, manage, and service through the Dispatch module. This allows for immediate creation of service calls for techs or attendants to address issues with the highest standard of performance.

- **Activate automatic or manual dispatching**
- **Define role-based administrative groupings, for supervisors to view floor activity and employee stats**
- **Employees select their desired dispatch zones**
- **Employees can view unassigned calls by transaction type**
- **Use in-app timers to observe task time to completion**
- **Manage Attendant Pays within Dispatch when both modules are purchased, with Dispatch built-in sub-module called Attendant Pays**

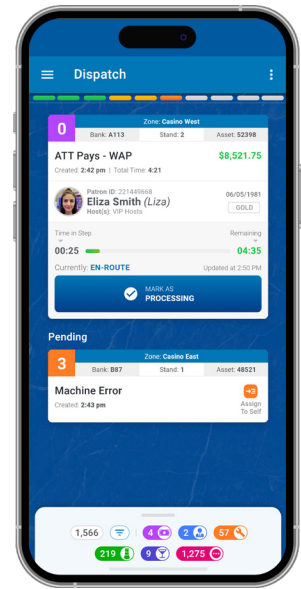

HAND PAY PROCESSING

Attendant Pays is available as a built-in sub-module within Dispatch. Casinos that have purchased both Attendant Pays and Dispatch will have access to processing jackpots via Konetic's Dispatch module. Handpays are a quick and convenient event for both players and employees with the Attendant Pays built-in workflow within Dispatch.

- **Print handpay transaction slips and tax forms, with digital signing**
- **Perform tax calculations and adjustments:**
 - Federal Taxes
 - State Taxes
- **Maintain a consistent, steps-based payout (including Cash Pay, Check Pay, Coupon Pay, and Cashless Wagering)**
- **Integration available with jackpot dispensing units**

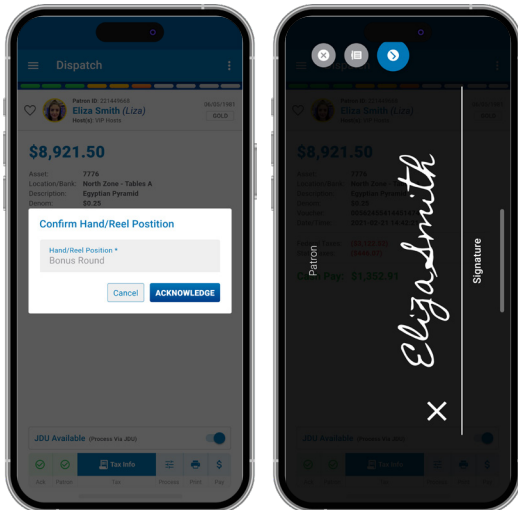

MEAL CODE

Meal Code is a built-in sub-module within Dispatch, to configure Machine Entry Access Log service codes. It is an employee mobile-based solution to replace paper MEAL cards where approved. It empowers employees to configure and submit MEAL Codes without relying on a desktop device or occupying an EGM.

- **Auto asset number population while responding to a dispatch ticket**
- **Enter Asset Numbers and MEAL Codes with validation checks**
- **Submit completed entries**
- **Search for MEAL code by number or description**

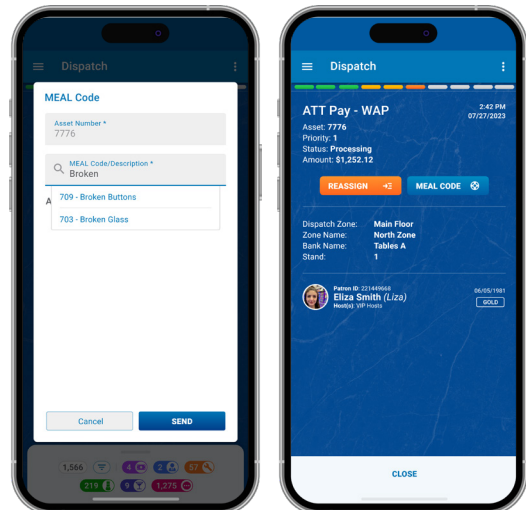

CASH CAN

Bring digital efficiency to your drop process and gain full visibility to which cash cans are 'in' and which are 'out' with Konetic's streamlined mobile Cash Can module. It allows permissioned employees to process Cash Cans through their mobile device via scanning (or entering the asset number manually) and then digitally processing the Cash Can—with all activity logged and updated in the database for full internal reporting and accountability.

- **Process Hot Cans and Cold Cans with the app**
- **Easily enter asset and can numbers using the mobile device camera or keyboard**
- **Activate automated updates to SYNKROS following completion of last scan**
- **Maintain Emergency Override functions and controls at the permissioned admin level**
- **Identify and perform Out Of Cycle drops**

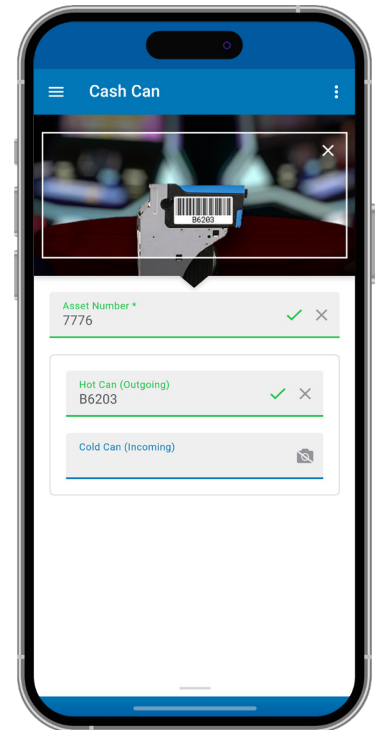

ATTENDANT PAYS

Konetic's Attendant Pays module allows permissioned employees to service jackpots, progressives, cancel credit, and disputes with convenient mobile tracking, logs, processes, and documents. Each step is completed digitally through the app's easy connected workflow—from associating patrons with jackpots to signing tax forms. And Attendant Pays' perfected worklog view puts all the right info at-a-glance.

- **Respond to any jackpot at any payment step:**
 - Jackpots
 - Progressives
 - Cancel Credit
 - Disputes
 - And more
- **Print handpay transaction slips and tax forms, with digital signing**
- **Perform tax calculations and adjustments:**
 - Federal Taxes
 - State Taxes
- **Maintain a consistent, steps-based payout (including Cash Pay, Check Pay, Coupon Pay, and Cashless Wagering)**
- **Create new patron account for jackpot winners that have yet to enroll**
- **Integration available with jackpot dispensing units**

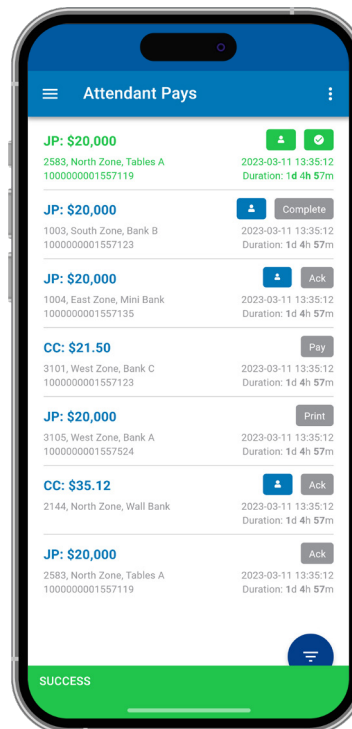

TITO REDEMPTION

Konetic's TITO Redemption module is built for speed and usability. This tool supports three types of input: manual input using the device keyboard, live input using the device camera, and scan input using an external handheld scanner. Users can input multiple vouchers once, and the Vouchers module supports both Ticket-in Ticket-out (TITO) tickets and cash mailers.

- Take advantage of two different input methods:
 - Manual input
 - Smartphone camera input
- Input both TITO tickets and cash mailers
- View a recent history for processed vouchers
- Keep mobile TITO redemptions going in any network situation with offline support (based on jurisdictional approval)

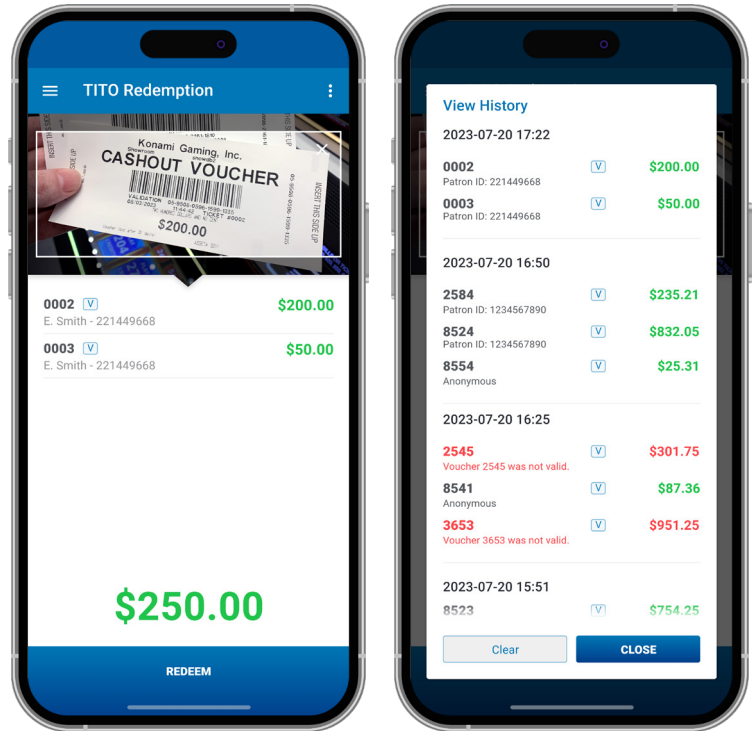

PROGRESSIVE SIGNS

Konetic offers a built-in Progressive Signs module, which allows teams to monitor progressive meter sign readings throughout their casino floor and complete updates directly through the app. Pull-up progressives in a flash with a simple name search and perform modifications in just moments.

- Search for progressives by name
- Short press progressives to tap into more details and update the amount
- Long press progressives to quickly update the amount
- Swipe progressives to easily process tiered progressives

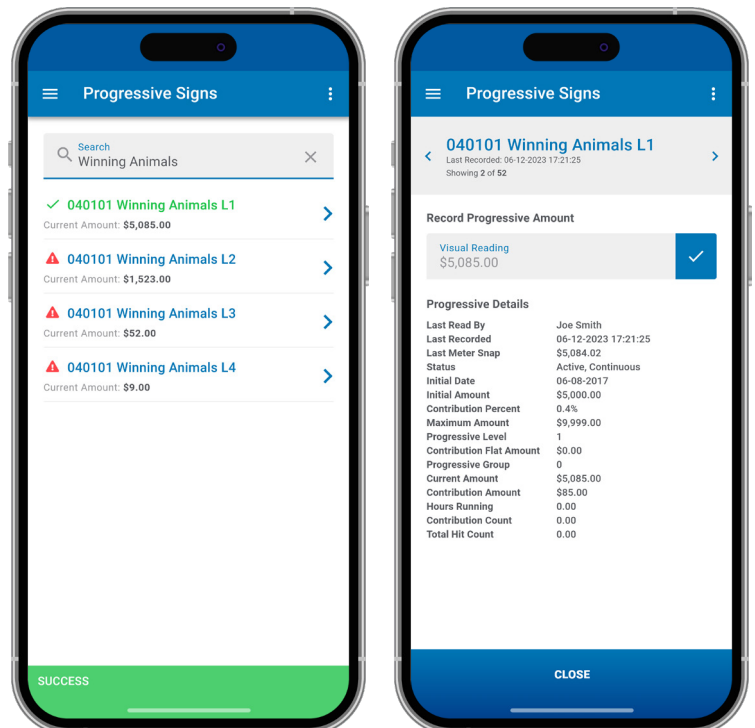

PATRON*

With Konetic's Patron module, player loyalty tools and information is always on-hand. Casino employees can search, view, update, and add patrons to the casino loyalty program directly on the app. And with the module's smart design, patron info is displayed in easy-to-reference stats for quick reference.

- Search, manage, & enroll patrons on-the-go
- Quick reference favorite and recently viewed patrons
- Save patron notes
- View history of patron interactions

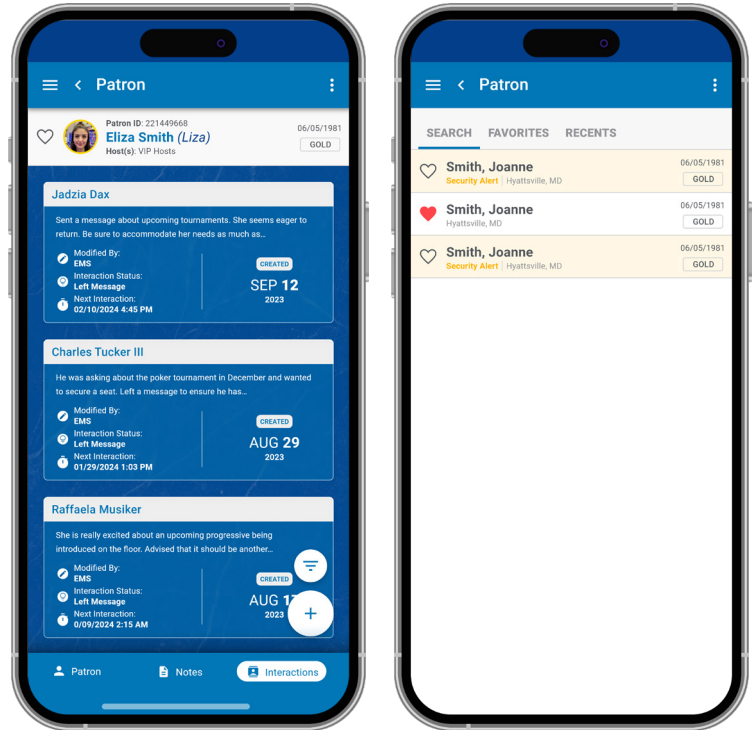

FINDER*

Casino teams can find patrons in real time with Konetic's Finder module. Whether searching for a specific carded patron or relevant uncarded patrons by selected criteria, and everything in between, Finder can pin point the location. It also allows casino employees to identify locations of EGM's and Table Games on the floor in times of need.

- Search for Patrons or Games on the casino floor in real time
- Select from a variety of criteria
- Discover if patrons are currently playing a game, or if a game is currently occupied
- Tap into saved favorite searches and recent searches

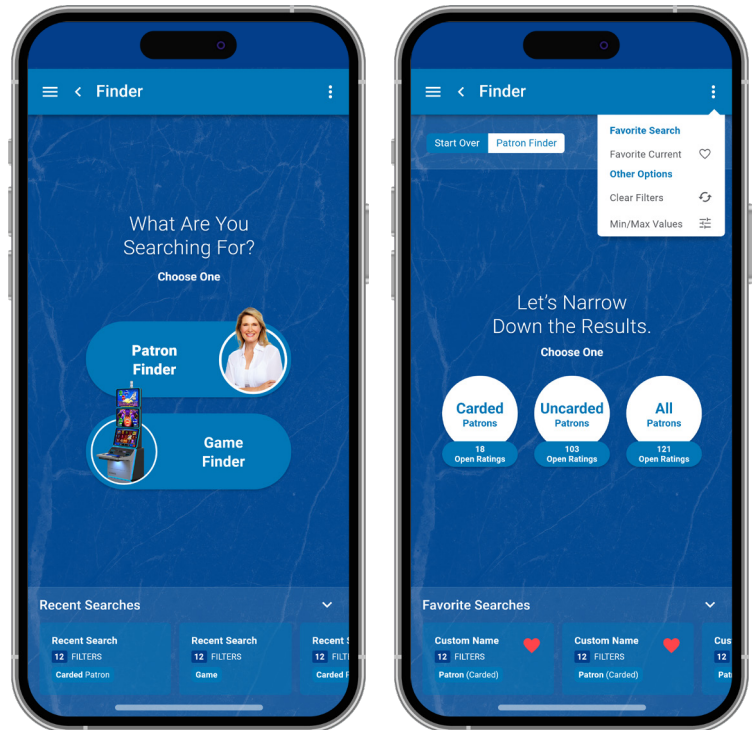

*Scheduled for release in SYNKROS v4.2

Contact your Konami SYNKROS Account Executive today for further information.

Konami Gaming, Inc.
 585 Konami Circle
 Las Vegas, NV 89119
 866.KGI.INFO